

# ALLISON (M74) LCT 1000/2000/2400

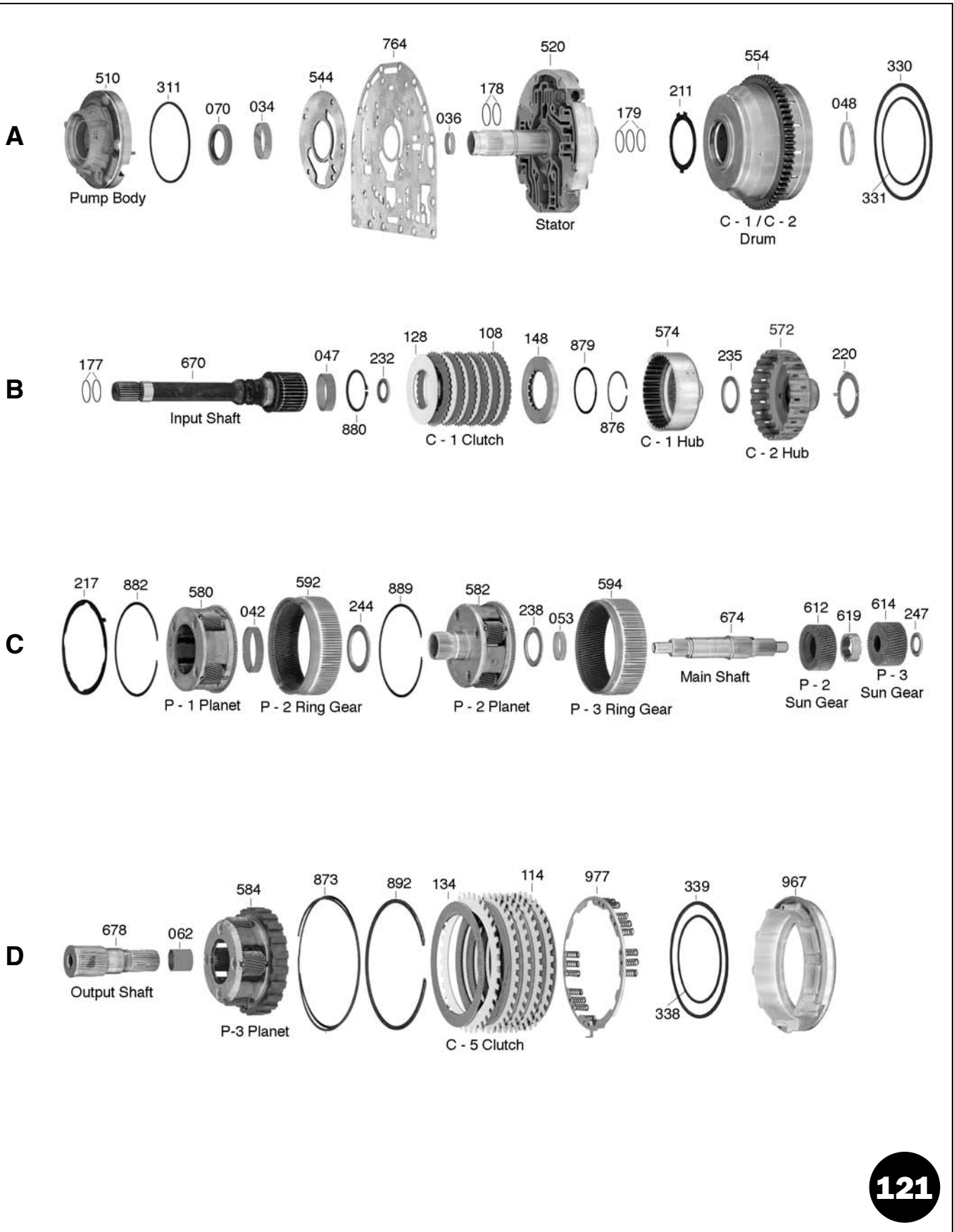

# ALLISON (M74) LCT 1000/2000/2400

LCT 1000

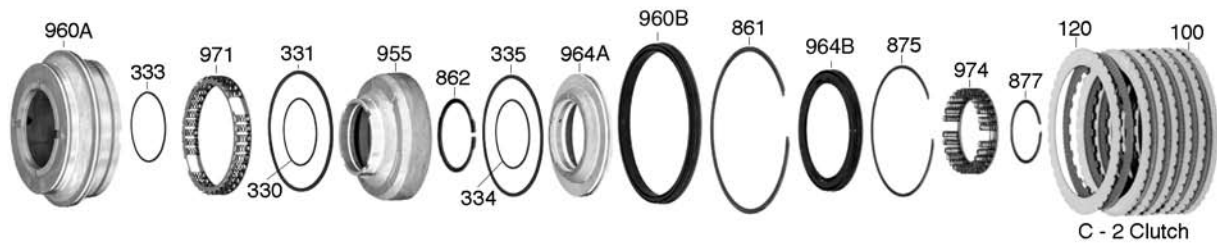

E

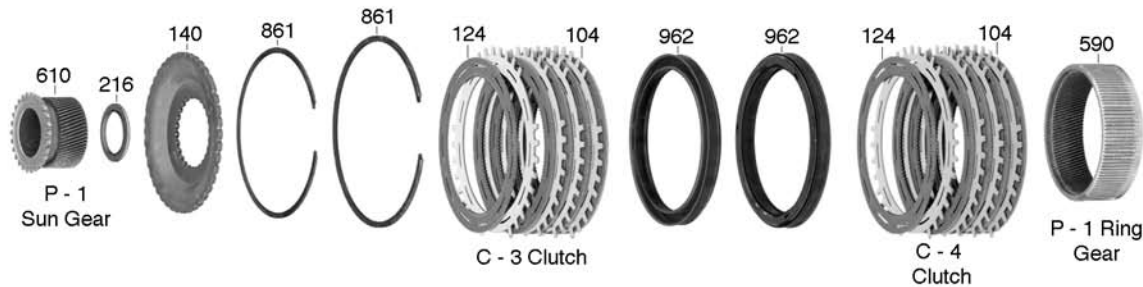

F

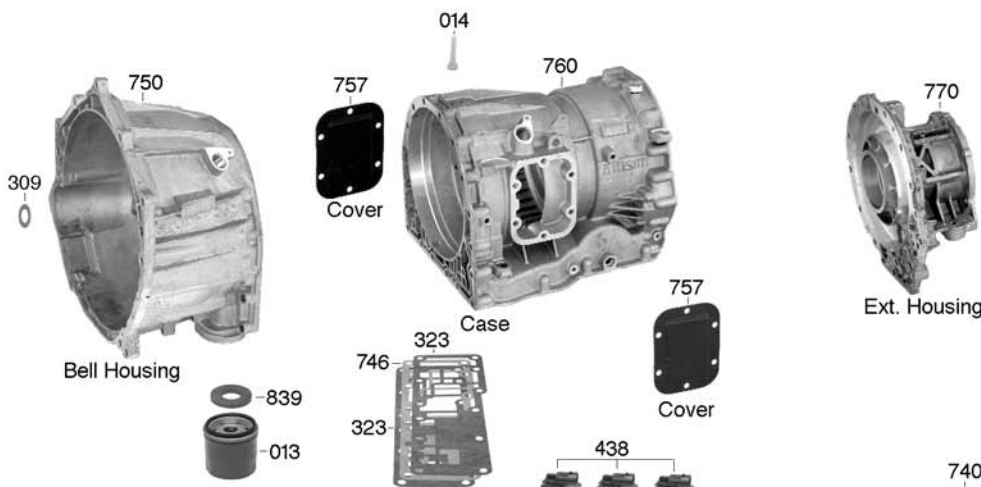

G

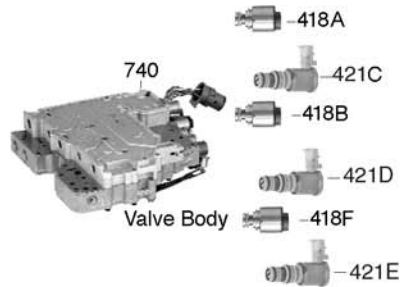

H



I

Deluxe Kit	008
Compliance Kit	007
Master Kit	006
Less Steel Kit	004
Overhaul Kit	002
Bushing Kit	030
Washer Kit	200
Bearing Kit	201
Technical Manual	400
Pump Part	507
Valve Body Parts	741
Case Parts	761

Note: Not all items are available for all transmissions

**121**

# ALLISON (M74) LCT 1000/2000/2400

To Get The Correct Parts, You Must Provide The Assembly Number Found On The Transmission Name Plate.

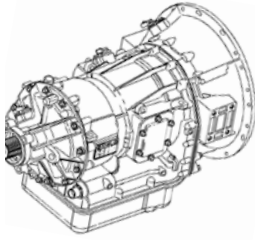

Allison Transmissions  
LCT 1000, 2000, 2400



121010



121010A

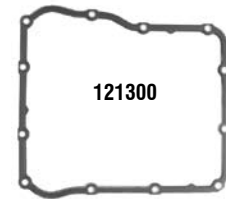

121300

ILL.	DESCRIPTION	QTY.	YEAR	PART NO.	REFERENCE NO.
<b>MASTER OVERHAUL KITS (WITH STEELS)</b>					
006H	Allison 1000, 2000, 2400 (w/ Bonded Pistons) .....	1	00-05	121006A	K1500
006H	Allison 1000, 2000, 2400 (w/ Bonded Pistons) .....	1	06-Up	121006B	N/A
<b>LESS STEEL KITS</b>					
004H	Allison 1000, 2000, 2400 (w/ Bonded Pistons) .....	1	00-05	121004A	K1500-LS
004H	Allison 1000, 2000, 2400 (w/ Bonded Pistons) .....	1	06-Up	121004B	N/A
<b>OVERHAUL KITS (W/ RINGS &amp; SEALS)</b>					
002H	Allison 1000, 2000, 2400 (w/o Bonded Pistons) .....	1	00-05	121002	N/A
002H	Allison 1000, 2000, 2400 (w/ Bonded Pistons) .....	1	00-05	121002A	K15900
002H	Allison 1000, 2000, 2400 (w/ Bonded Pistons) .....	1	06-Up	121002B	N/A
<b>FILTER KITS</b>					
011I	Filter Kit, Shallow Pan (Black) .....	1	00-Up	121011	FK15800
011I	Filter Kit, Deep Pan (White) .....	1	00-Up	121011A	FK15800A
<b>FILTERS</b>					
010I	Shallow Pan (Black) .....	1	00-Up	121010	15800
010I	Deep Pan (White) .....	1	00-Up	121010A	15800A
013H	Spin-on External .....	1	00-Up	121013	14802
<b>BUSHINGS</b>					
030H	Bushing Kit .....	1	00-Up	121030	K15905
034A	Front Pump Body .....	1	00-Up	121034	15005
<b>METAL CLAD SEALS</b>					
070A	Front .....	1	00-Up	121070	15200
074G	Rear .....	1	00-Up	121074	15850
<b>FRICTION PLATES</b>					
108B	C1 Clutch - External Teeth .....	6	00-Up	121108	15100
100E	C2 Clutch .....	6	00-Up	121100	15101
100E	C2 Clutch Z Pack .....	6	00-Up	121100K	K15101Z
104F	C3 Clutch .....	4	00-Up	121104	15102
104F	C4 Clutch .....	5	00-Up	121104	15102
114D	C5 Clutch .....	6	00-Up	121114	15103
<b>STEEL PLATES</b>					
128B	C1 Clutch - Internal Teeth .....	6	00-Up	121128	15105
120E	C2 Clutch .....	7	00-Up	121120	15106
124F	C3 Clutch .098" .....	3	00-Up	121124	15107
124F	C4 Clutch .098" .....	4	00-Up	121124	15107
124F	C3 & C4 Apply Plate .125" .....	1	00-Up	121124A	N/A
134D	C5 Clutch .078" .....	AR	00-Up	121134A	N/A
134D	C5 Clutch .098" .....	6	00-Up	121134	15108
134D	C5 Clutch .118" .....	AR	00-Up	121134B	N/A

# ALLISON (M74) LCT 1000/2000/2400

**To Get The Correct Parts, You Must Provide The Assembly Number Found On The Transmission Name Plate.**

ILL.	DESCRIPTION	QTY.	YEAR	PART NO.	REFERENCE NO.
<b>VALVE BODY RECALIBRATION KITS</b>					
165H	Shift Kit®, Standard, HD and Racing (5 Speeds) (Transgo®).....	1	01-05	T121165	K15908
165H	Junior Shift Kit® (6 Speeds) (Transgo®).....	1	05-Up	T121167	K15908B
<b>GASKETS &amp; O-RINGS</b>					
300I	Gasket, Pan (Bonded Rubber).....	1	00-Up	121300	13200R
309	Seal, Bell Bolt.....	1	00-Up	121309	N/A
311	O-Ring, Pump.....	1	00-Up	121311	N/A
318	Gasket, Bell Housing Plate (Front) (can use 121318B).....	1	00-Up	121318	N/A
318	Gasket, Bell Housing Plate (Front) (2nd Design, Retros 00-Up).....	1	00-Up	121318B	N/A
318	Gasket, Bell Housing Plate (Rear).....	1	00-Up	121318A	N/A
<b>TECHNICAL MANUALS</b>					
400H	Tech Manual.....	1	00-Up	121400	15Y01
400H	Service Manual - OEM.....	1	00-Up	121400M	TM-1000M
400H	Parts Manual - OEM.....	1	00-Up	121400P	TM-1000P
400H	Trouble Shooting Manual - OEM.....	1	00-Up	121400T	TM-1000T
<b>ELECTRICAL COMPONENTS</b>					
410H	Neutral Start/ Backup Switch (MLPS) 2 Connector.....	1	01-E03	121410	15A-199
410H	Neutral Start/ Backup Switch (MLPS) 1 Connector.....	1	L03-Up	121410A	15A-199A
418H	Solenoid, "A" Trim (Normally Closed).....	1	00-Up	121418	5A-198
418H	Solenoid, "B" Trim (Normally Open).....	1	00-Up	121418A	5A-199
418H	Solenoid, "F" Trim (PWM).....	1	00-Up	74418E	5A-187
421H	Solenoid, Shift ("C", "D" & "E").....	3	00-Up	74418EA	5A-192
421H	Solenoid, Modulated Pressure Control ("G").....	1	04-Up	74418EA	5A-192
438H	Sensor, Input, Output & Turbine.....	3	00-Up	121438	20A-199
442H	Switch Assembly, Pressure Manifold.....	1	00-Up	14411A	15D-176
446H	Wiring Harness Assembly (Internal) 6 Solenoids.....	1	01-E03	121446	35A-199
446H	Wiring Harness Assembly (Internal) 7 Solenoids.....	1	L03-Up	121446A	35A-199A
446H	Repair Kit, Park / Neutral Switch Harness.....	1	00-Up	74446K	35A-114K
<b>HARD PARTS</b>					
<b>Prefix Key: D = OEM, A = Aftermarket New, R = Remanufactured</b>					
<b>PUMPS</b>					
510A	Pump Body w/ Gears.....	1	00-Up	121510	N/A
510A	Pump Body Kit (incl Body, Gears, Plate, Bushing & Seal).....	1	00-Up	121510K	15920
<b>PUMP COMPONENTS</b>					
544A	Pump Plate.....	1	00-Up	121544	15922
507H	Pump Kit, Lock-up Boost Kit (00-03).....	1	00-03	121507K	K15888
507H	Pump Kit, Lock-up Boost Kit (04-07).....	1	04-07	121507AK	K15888A
507H	Springs, Lube Reg. / Converter Relief.....	1	00-03	121507A-3	K15882
<b>DRUMS &amp; CLUTCH HUBS</b>					
554A	C1/C2 Drum w/ PTO Gear.....	1	00-Up	121554	15950
570B	C2 Hub.....	1	00-Up	121572	15955
<b>PLANETS</b>					
580C	Planet, Front (P1).....	1	00-Up	121580	15962
582C	Planet, Center (P2).....	1	00-Up	121582	15964
584D	Planet, Rear (P3).....	1	00-Up	121584	15966
590	Ring Gear (P12).....	1	00-Up	121590	N/A
592C	Ring Gear (P2).....	1	00-Up	121592	N/A
594C	Ring Gear (P3).....	1	00-Up	121594	N/A

LCT 1000

